

Heaven US

standalone

82.67"x82.67" h.33.85"

Technical features	
Max water capacity	275 gal
Whirlpool jets	16 jets 14 jets plus
Dimensional features	
Packaging volume	167.4 ft ³
Dry weight	705.4 lb
Wet weight	3461.25 lb
Electrical features	
Voltage	2 x 120 volt
Amperage	36.5 A
Frequency	60 Hz
WHIRLPOOL absorbed power	0.69 Kw 1st speed 2.02 Kw 2nd speed
Temperature controller	5.5 Kw
AIRPOOL motor power	810 watt (only Ba06)
Maximum total absorption	8.4 Kw

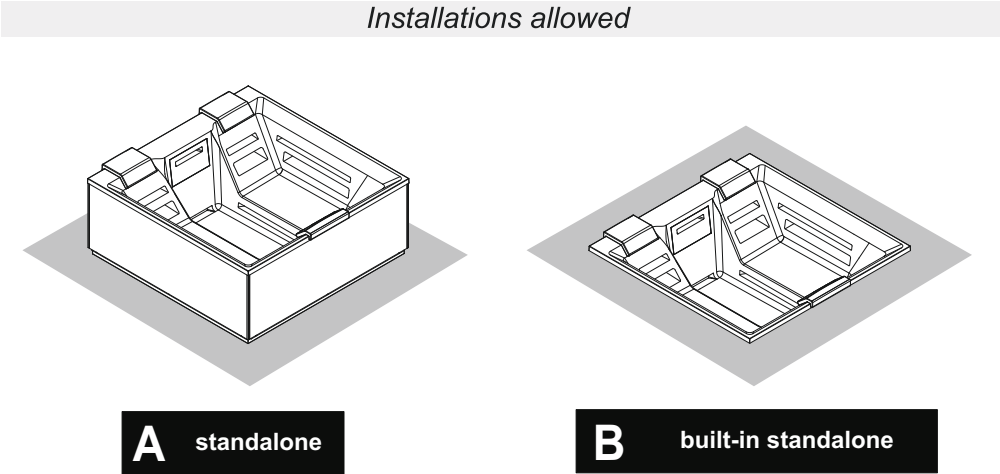
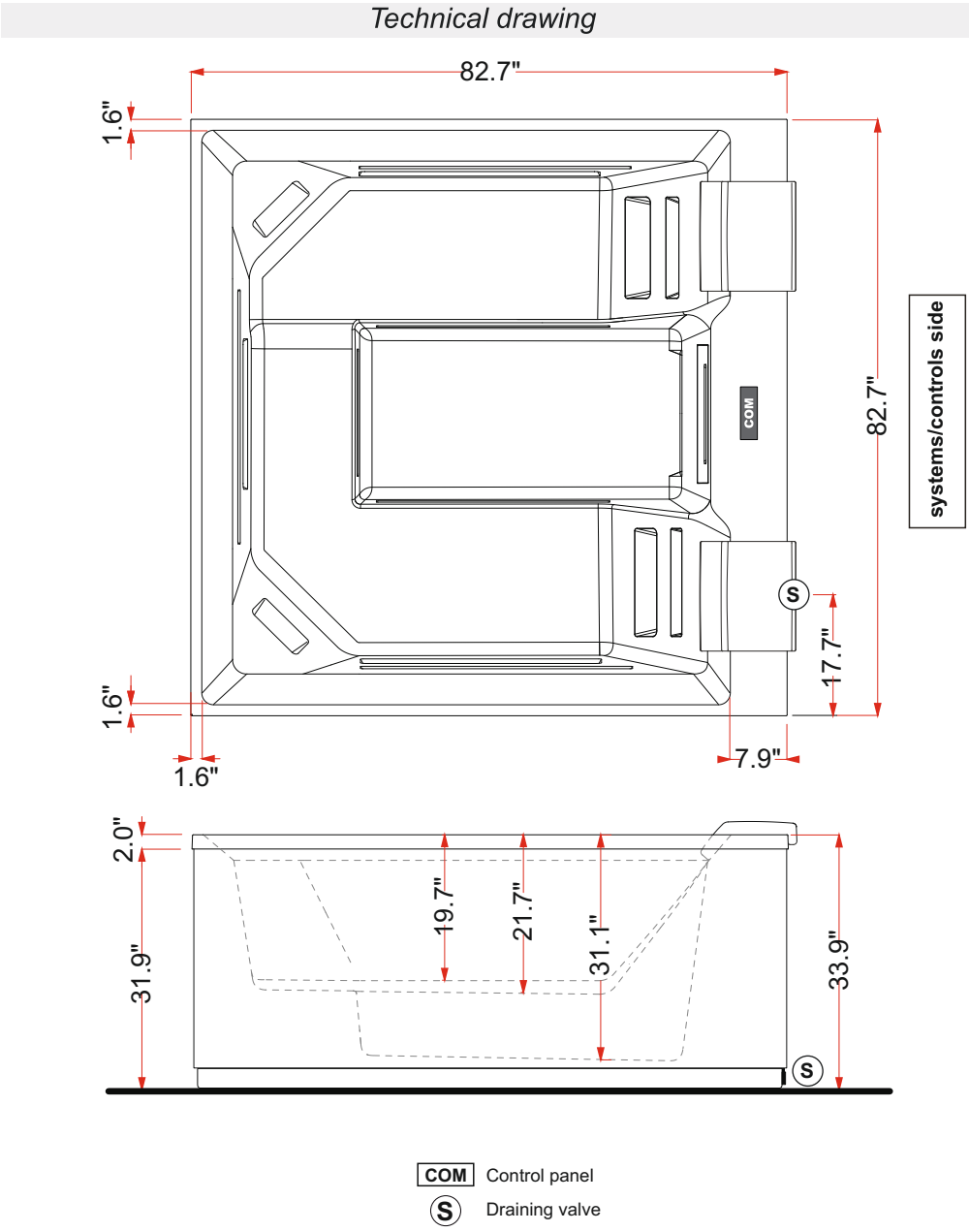

Heaven

82.67"x82.67" h.33.85"

Hydraulic installation - Electrical installation

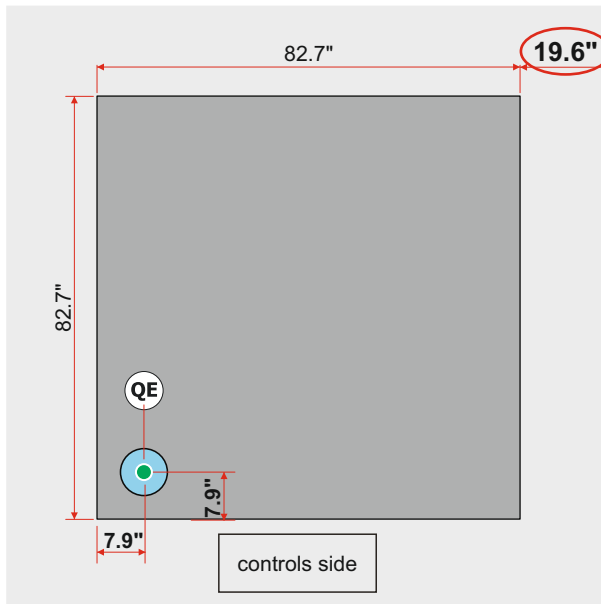

standalone - mandatory empty perimeter area

built-in - mandatory area for technical room for inspection

The connections must be placed inside the blue area

QE Electrical connection



It is recommended to install upstream of the hydraulic system of filter faucets. The company declines problems arising from failure to install them

NOTE

- The electrical system to which the mini-pool will be connected must comply with CEE standards
- The minipool should be connected to a mains isolator (magnetothermic switch) with min. 3mm spaced contacts and an RCD (differential switch) of max 30mA
- It is necessary that the building electrical system is equipped with a bipolar disconnecting device
- The electrical system must be equipped with an efficient ground system
- The minipool must be connected to the building's ground system permanently

Main components

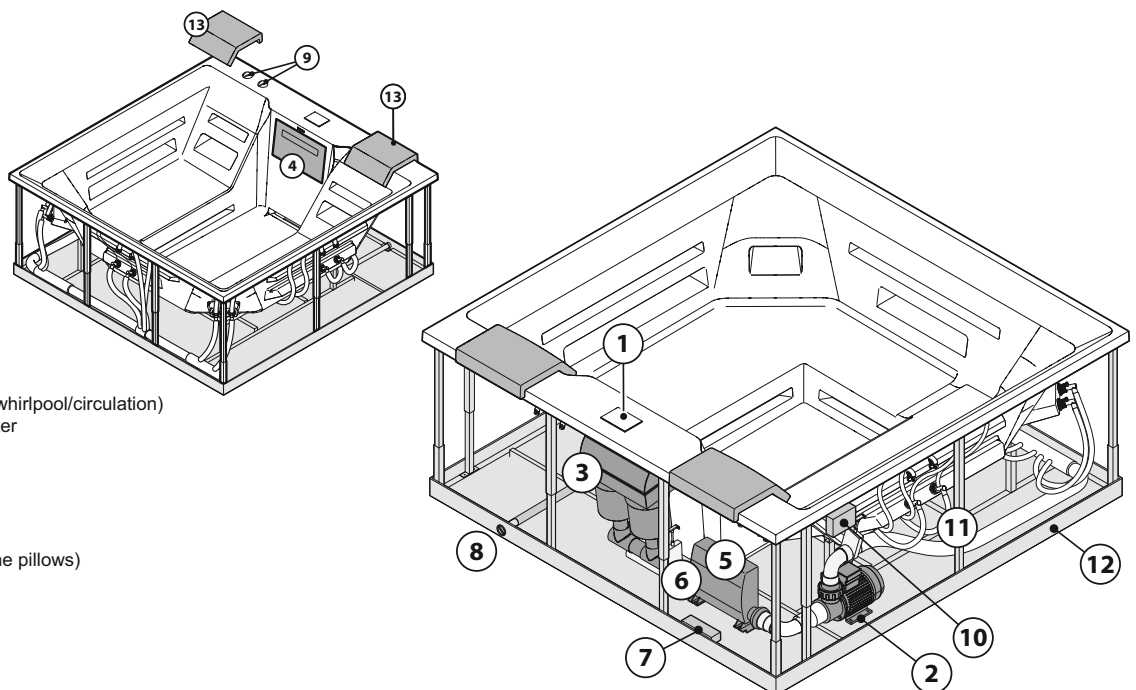

- Control panel
- Motor pump 2 speed (whirlpool/circulation)
- Skimmer with paper filter
- Skimmer cover panel
- Control unit
- Heater
- Blower pump (Ba06)
- Drainage tap
- Air regulators (under the pillows)
- Ozonizator
- Frame
- Base
- Pillows

Heaven

82.67"x82.67" h.33.85"

Free-standing installation

standalone - mandatory empty perimeter area

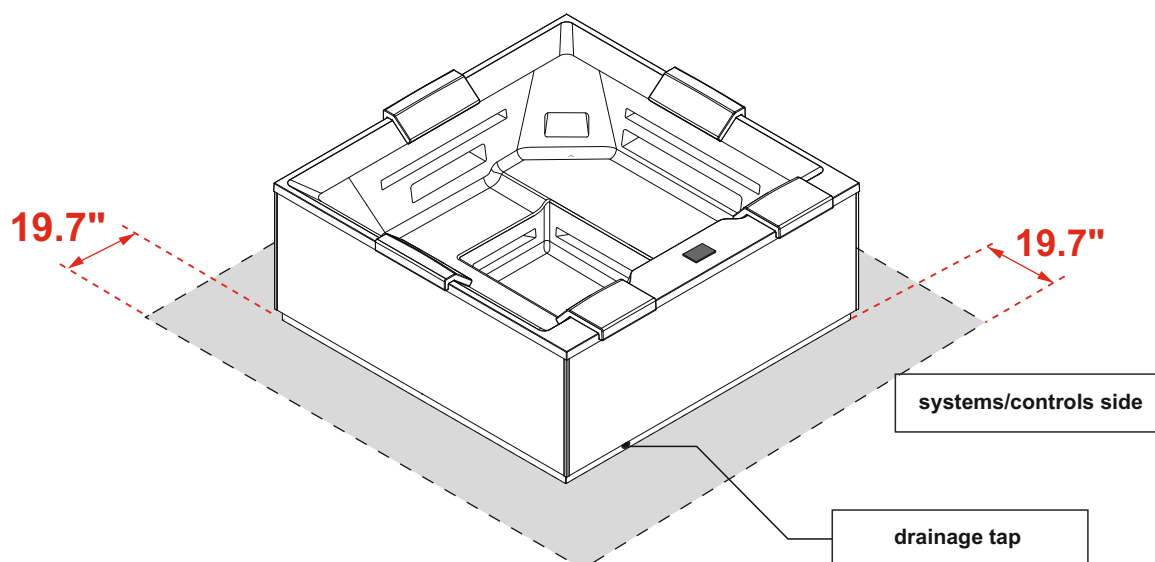

Preparation of the installation site

Concrete slab h. 3.9" minimum, perfectly level and able to support the weight of the minipool + the weight of the people within

B Non-slip flooring

A Drainage grates

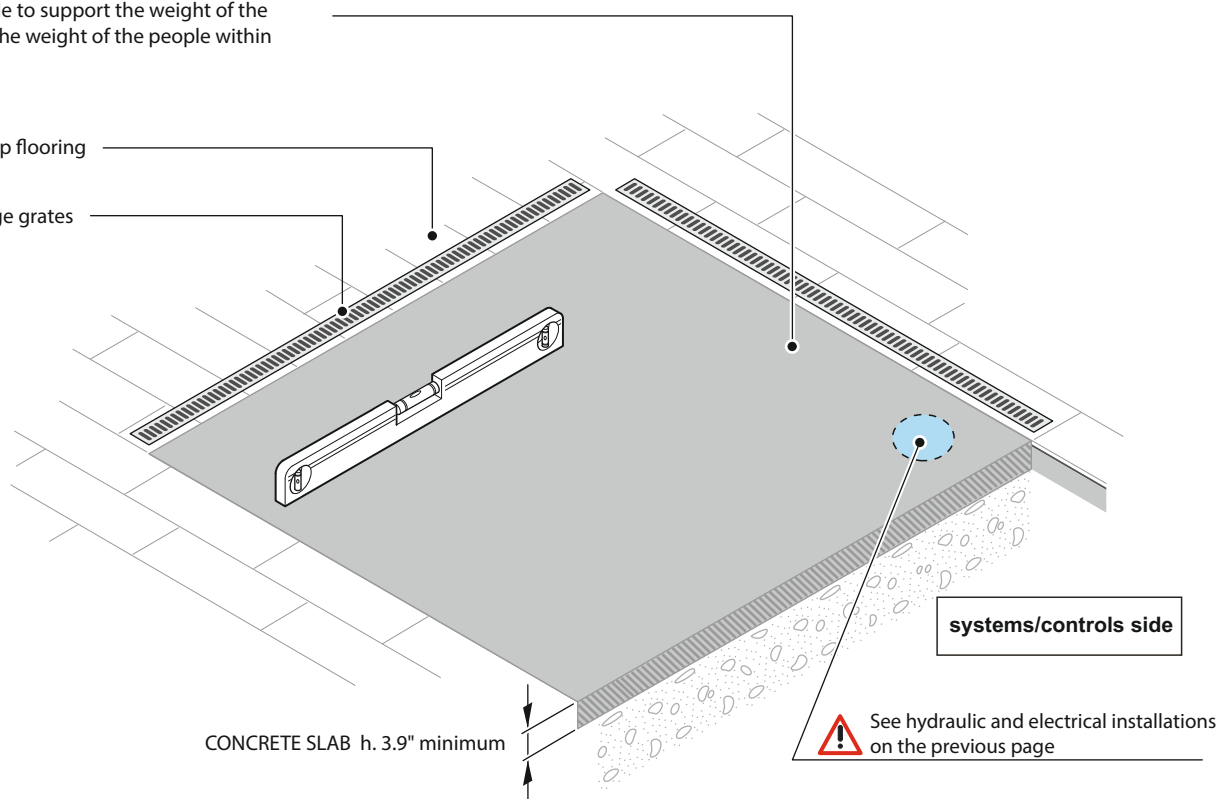

Heaven

82.67"x82.67" h.33.85"

Built in installation

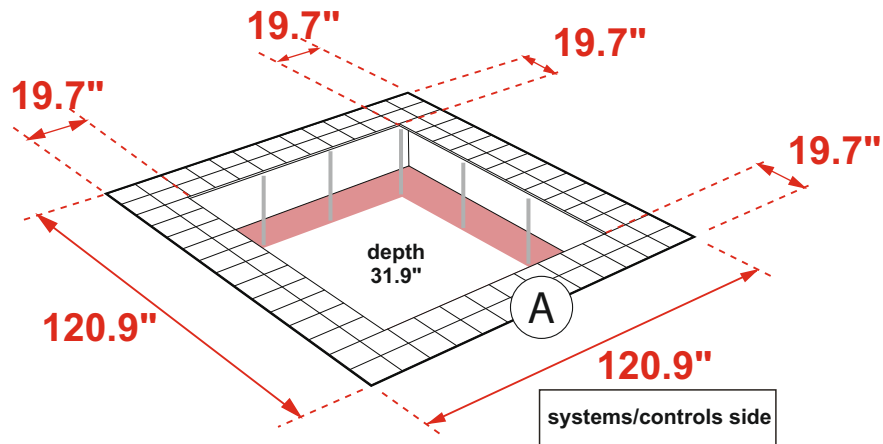

A INSPECTION COMPARTMENT DETAILS

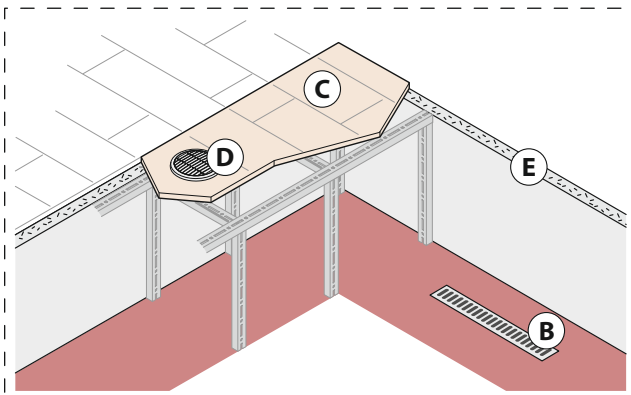

- A** Perimetric inspection compartment of 19.7" with removable floor
- B** Internal drainage grates
- C** Non-slip flooring
- D** n°2 Ø5.9" vents to ensure proper ventilation of the technical compartment
- E** Insulation: prevents damage from freezing and condensation

NB: we recommend to let the spa discharge its weight on the base and not on the edges.

We advice to fix the last line of tiles near the edge once the installation is finished, the result will be a good match between the spa and the covering.

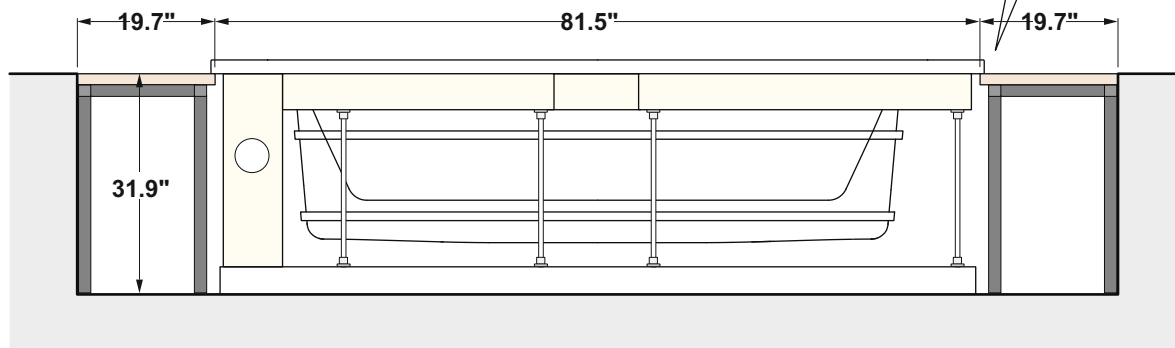
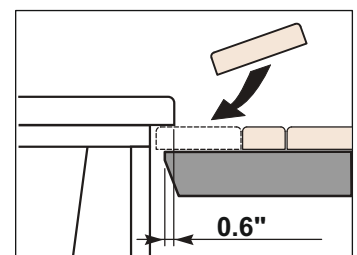

Built in installation with lifter

Heaven
82.67"x82.67" h.33.85"

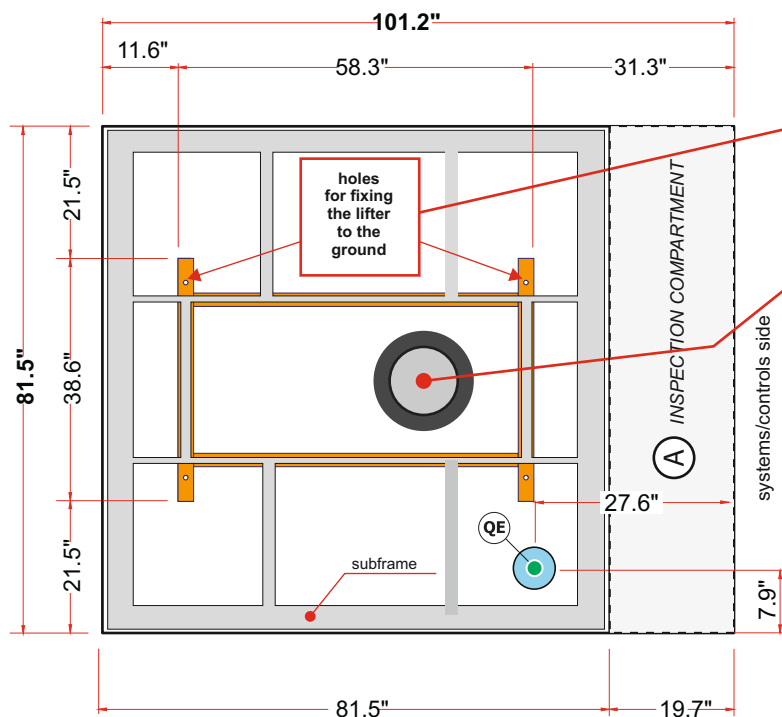

⚠ ATTENTION

THE AIR CHAMBER OF LIFTER MUST BE ALWAYS ON THE SAME SIDE OF THE CONTROL PANEL OF THE MINIPOOL

FIXE THE LIFTER TO THE GROUND ONLY AFTER YOU MAKE THE EXCURSION TEST WITH THE SUBFRAME, WITHOUT THE MINIPOOL.

The connections must be placed inside the blue area

● QE Electrical connection

⚠ It is recommended to install upstream of the hydraulic system of filter faucets. The company declines problems arising from failure to install them

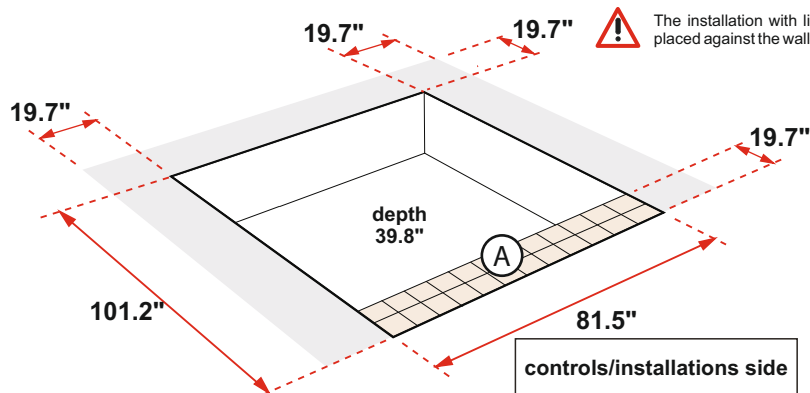

⚠ The installation with lifter is in the center of the room, no side can be placed against the wall, a minimum distance of 19.7" be maintained.

Like built-in installations (see previous pg.) must be installed an internal drainage grates, a non-slip flooring, two vents Ø5.9" to ensure a proper ventilation of the technical compartment and an insulation to prevent damages from freezing and condensation.

Ⓐ INSPECTION COMPARTMENT with removable floor (systems side only)

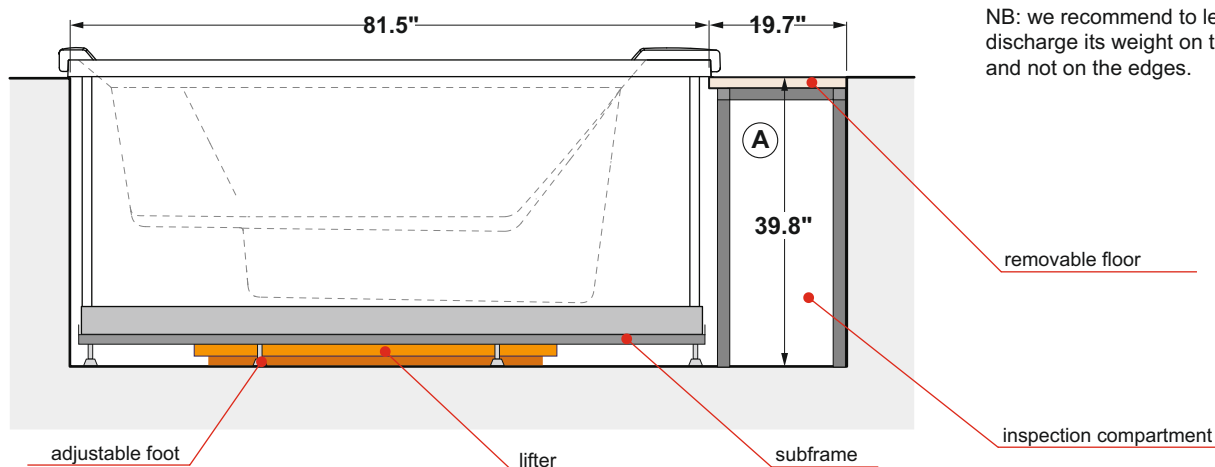

NB: we recommend to let the spa discharge its weight on the base and not on the edges.